

NOTE:
 ALL DIMENSIONS TO BE CHECKED ON SITE. NO
 DIMENSIONS TO BE SCALED FROM THIS DRAWING.
 THIS DRAWING IS TO BE READ IN CONJUNCTION
 WITH RELEVANT CONSULTANTS DRAWINGS
 THIS DRAWING IS COPYRIGHT

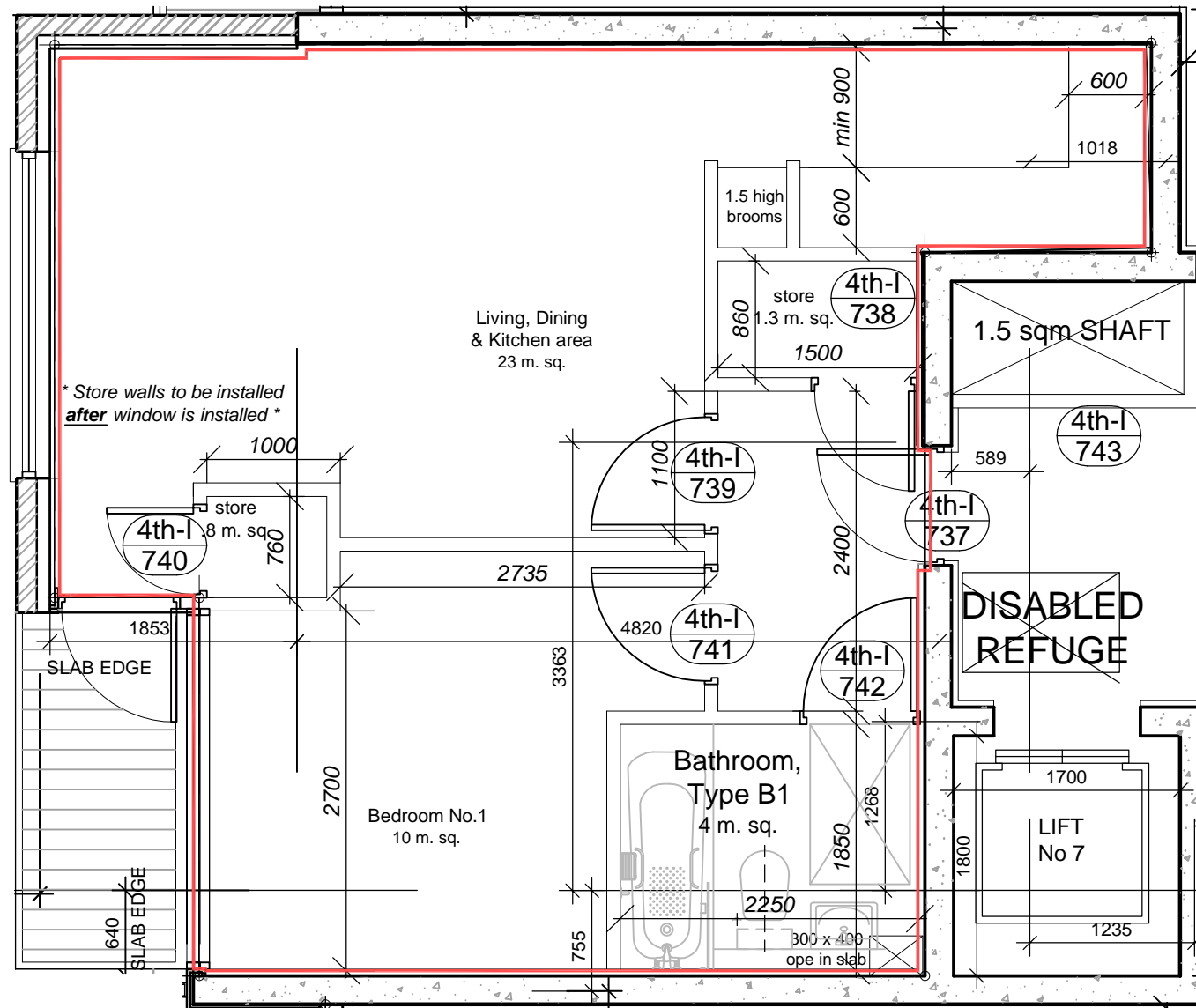

Fourth Floor Residential Layout
 Apartment No. 511 (1 Bed)
 Area: 45 m²

REV.	DATE	DESCRIPTION	DRAWN

**HENRY J LYONS
 AND PARTNERS**
 ARCHITECTS

47/48 PEARSE STREET, DUBLIN 2
 T +353 1 8883333 F +353 1 8883322
 hjl@hjl Lyons.com www.hjl Lyons.com

COPYRIGHT©

CLIENT
 Sherborough Enterprises Limited

PROJECT
 Cathedral Court
 at New Street, Dublin 8.

DRAWING
 Fourth Floor Plan
 Block 500: Apartment 511

Fourth Floor: Apartment 511

SCALE:	DATE:	JOB NO.	
1:50	Jan 2006	80-0072	
DRAWN:	CAD REF:	CHECKED:	
NB			
BLOCK	DRAWING NUMBER	ZONE	REVISION